

WINDING CONSTANT	TOL	SYM	UNITS	VALUE
DC RESISTANCE@25C	+ 10%	R	OHMS	11.7
VOLTAGE @ Fp	NOMINAL	Vp	VOLTS	16.1
CURRENT @ Fp	NOMINAL	Ip	AMPS	1.4
TORQUE SENSITIVITY	+ 10%	Kt	N-m / A	0.16
BACK EMF CONSTANT	NOMINAL	Kb	V/Rad/Sec	0.16
INDUCTANCE	+ 30%	L	mH	2.0
ACTUATOR PARAMETER		SYM	UNITS	VALUE
PEAK TORQUE *		Tp	N-m	0.22
CONTINUOUS STALL TORQUE **		Tcs	N-m	0.12
ACTUATOR CONSTANT		Ka	N-m / <w>	0.05
ELECT TIME CONSTANT		Te	milli-sec	0.17
POWER I2R@Fp		Pp	W	22.1
TOTAL STROKE(ANGULAR)		S	degree	32
CLEARANCE ON SIDE OF COIL		CL	mm	0.5
THERMAL RESISTANCE ***		Θth	C / W	18.5
MAX WINDING TEMP		Tmax	C	155
WEIGHT OF COIL ASSEMBLY		WTc	g	22
INERTIA OF COIL ASSEMBLY		Ic	g-cm2	130
WEIGHT OF FIELD ASSEMBLY		WTF	g	220
WEIGHT OF ACTUATOR		WTA	g	242

\* 5 sec @ 25C ambient, 155C coil temp.  
 \*\* 25C ambient, 155C coil temp.  
 \*\*\* In free air.

3. LEAD WIRE LENGTH 300MIN LONG  
 2. INSULATION RESISTANCE: 100 MEGOHMS MINIMUM AT 500 VDC.

▲ A POSITIVE (+) VOLTAGE APPLIED TO THE RED LEAD WILL PRODUCE A FORCE ON THE COIL ASSEMBLY IN CLOCKWISE (CW) DIRECTION.

NOTES: UNLESS OTHERWISE SPECIFIED

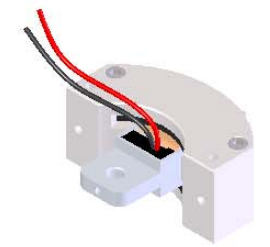
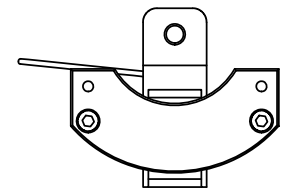
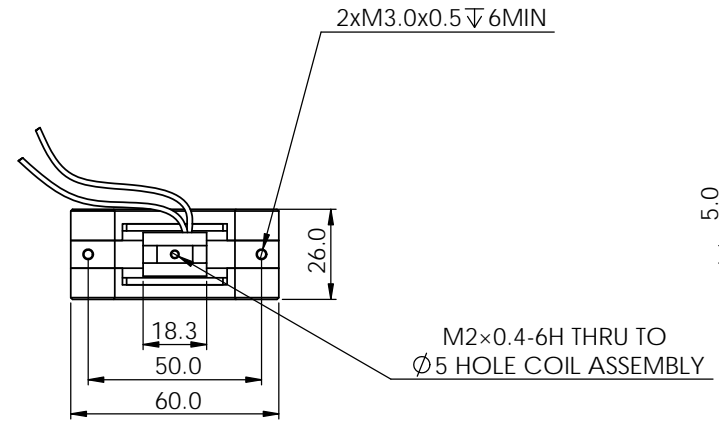
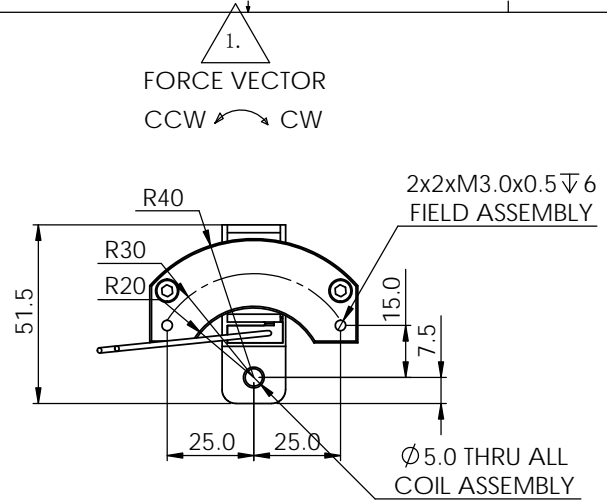

REV	ECO NO.	DESCRIPTION	DRN	APP'D	Q.A	DATE
X1	---	INITIAL RELEASE	LHM	SGM		2008-12-12

UNLESS OTHERWISE SPECIFIED:		NAME	DATE	Tongmao Electronics
DIMENSIONS ARE IN MM TOLERANCES: ANGULAR: MACH ±0° 30' ONE PLACE DECIMAL ±0.25 TWO PLACE DECIMAL ±0.1		LHM	2008-12-12	
INTERPRET GEOMETRIC TOLERANCING PER: ANSI Y14.5M-1982.		CHECKED		TITLE: <h1>VOICE COIL ACTUATOR</h1>
		ENG APPR.	SGM 2008-12-12	
		MFG APPR.		
DO NOT SCALE DRAWING		Q.A.		